



Receive email alerts based on your search criteria.

Create my alert



#4, 205019 100 RANGE Road SE, Rural Lethbridge County, Alberta - \$650,000

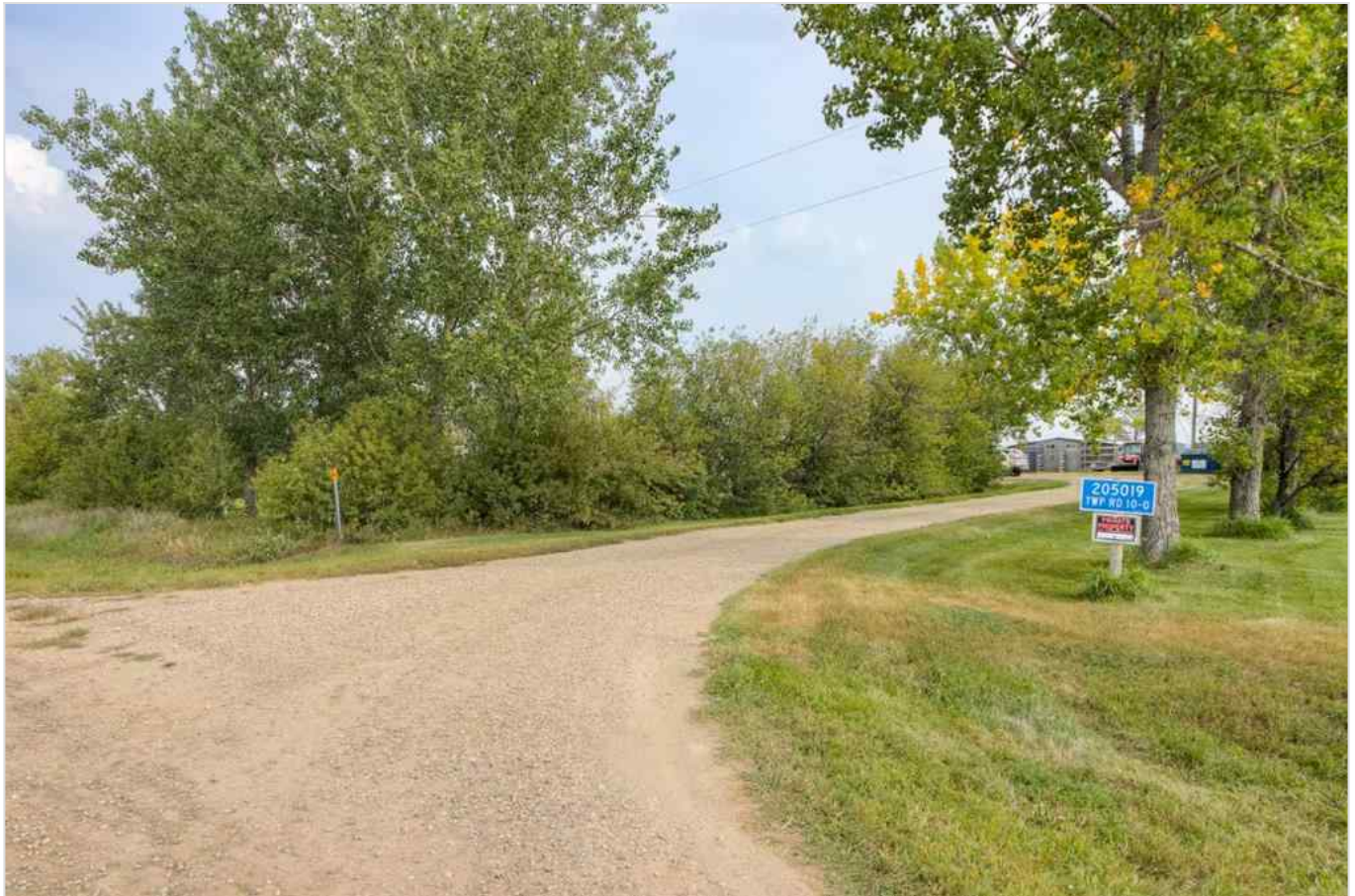

Main Photo

Property Description

Just 15 minutes from downtown Lethbridge, this 8.94 acreage offers the perfect blend of country charm and city convenience. Whether you're dreaming of starting a hobby farm or simply escaping the hustle of the city, this property is made for peaceful living. The cozy home features a kitchen open to the dining room, a welcoming living room, and a main floor primary bedroom with full bathroom nearby. Upstairs is a quaint half-story bedroom, while the basement provides a family room, additional bedroom or den, and plenty of storage. Outside, the spacious shop is perfect for all your tools and toys, complete with its own bathroom for cleaning up after a day of projects. Evenings are best spent gathered around your firepit,



[Sean Gillis](#)

RE/MAX Grande Prairie

sean@seangillis.ca

P:

M: 780.897.3520

watching the sun set and enjoying the quiet of country life.

REALTOR Referral



REALTOR®

Mobile: 780.897.3520

Email: sean@seangillis.ca

Website: <https://www.real-estate-homes.ca/>

Courtesy Of: REAL BROKER



[Sean Gillis](#)

RE/MAX Grande Prairie

sean@seangillis.ca

P:

M: 780.897.3520