

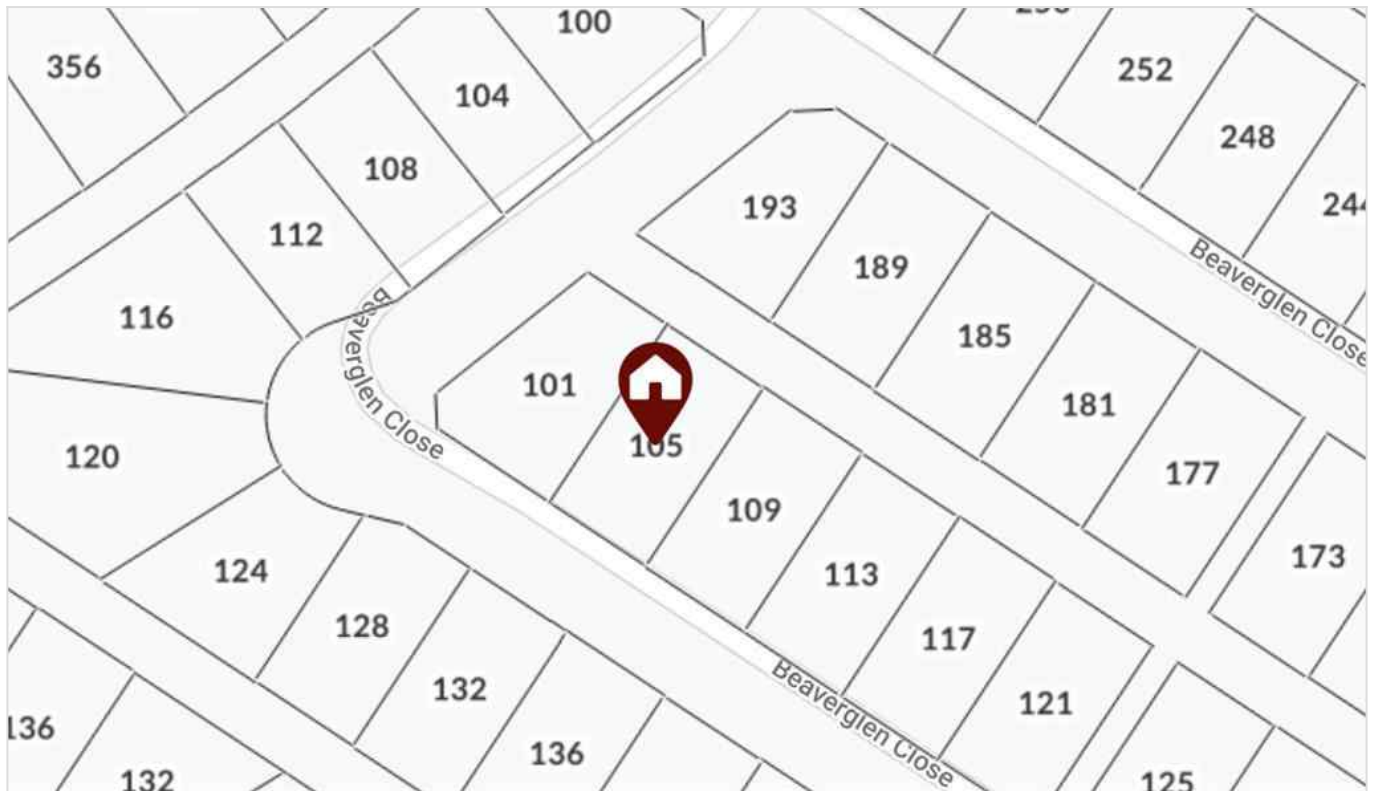

105 Beaverglen Close , Fort McMurray, Alberta - \$109,900



Main Photo

Property Description

Build your DREAM HOME here with over 6600sqft of space to work. This lot is 60' wide x 110' deep offering options for your new build. This great neighbourhood offers elementary schools, shopping plaza, hockey arena, dog park and miles of walking trails. Start your planning today.

REALTOR Referral



REALTOR®

Mobile: N/A

Email: N/A

Website: <https://www.real-estate-homes.ca/>

Photos
Coming
Soon



P:

Courtesy Of: EXP REALTY



P: