

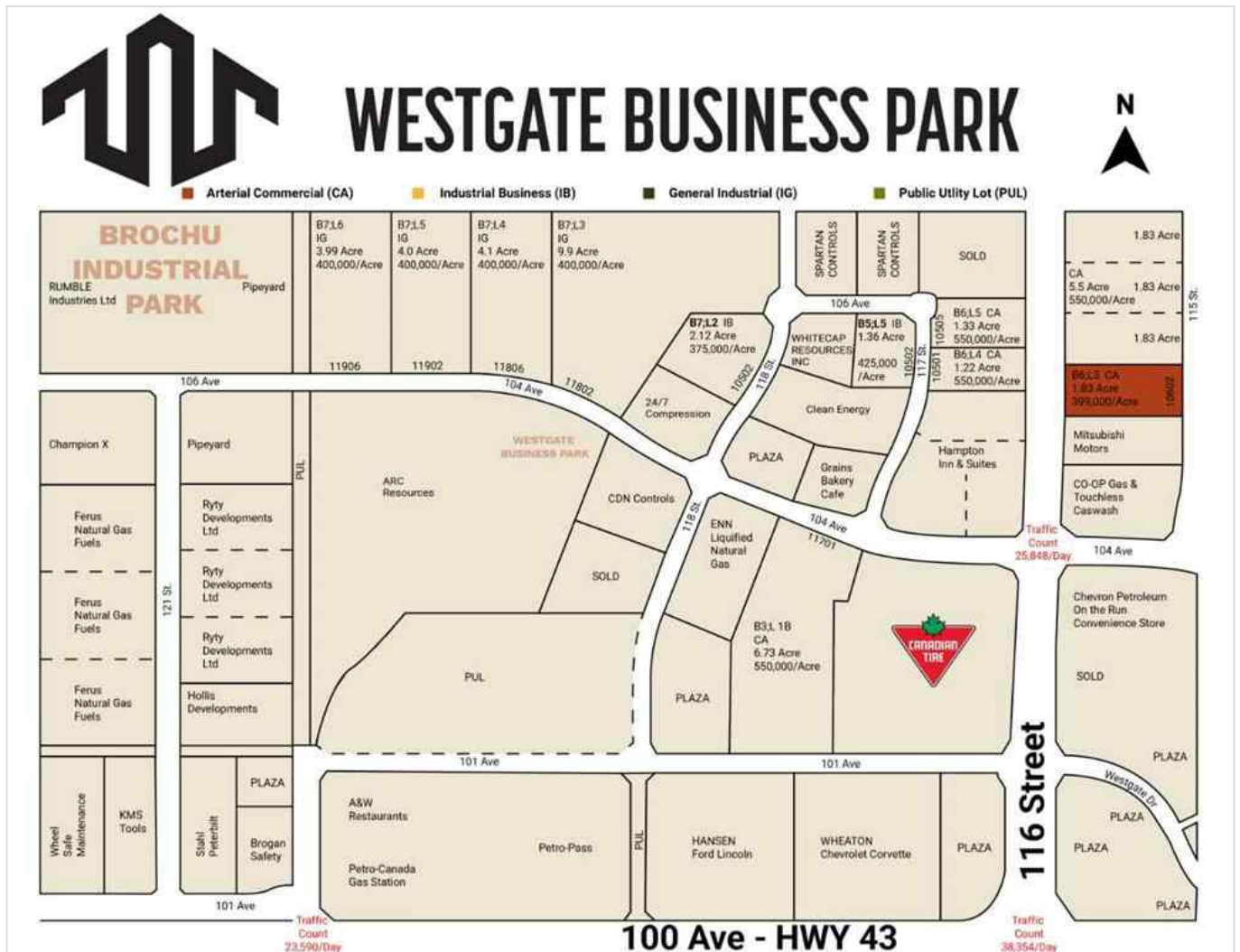

10602 115 Street , Grande Prairie, Alberta - \$730,170



Main Photo

Property Description

Final Phase of Westgate Business Park, Grande Prairie's premier power center for retail and commercial business.

Full Municipal services available on this 1.83 Acre commercial lot that offers over 152 feet of frontage on 116 street.

Direct access to all major transportation routes. Close to Grande Prairie Regional Airport and the new Grande Prairie

Regional Hospital with signalized intersections. Highest standards of development with wide roads and

sidewalks. Wexford Developments offers build-to-suit options to bring any design to life for your business. Call your Commercial REALTOR ® today for additional information.

REALTOR Referral



REALTOR®

Mobile: N/A

Email: N/A

Website: <https://www.real-estate-homes.ca/>

Courtesy Of: RE/MAX Grande Prairie



P: